



# ALBERT HALL

BRUSSELS

PARKING,  
ACCESS  
& SHUTTLES



# PARKING

Parking VIP

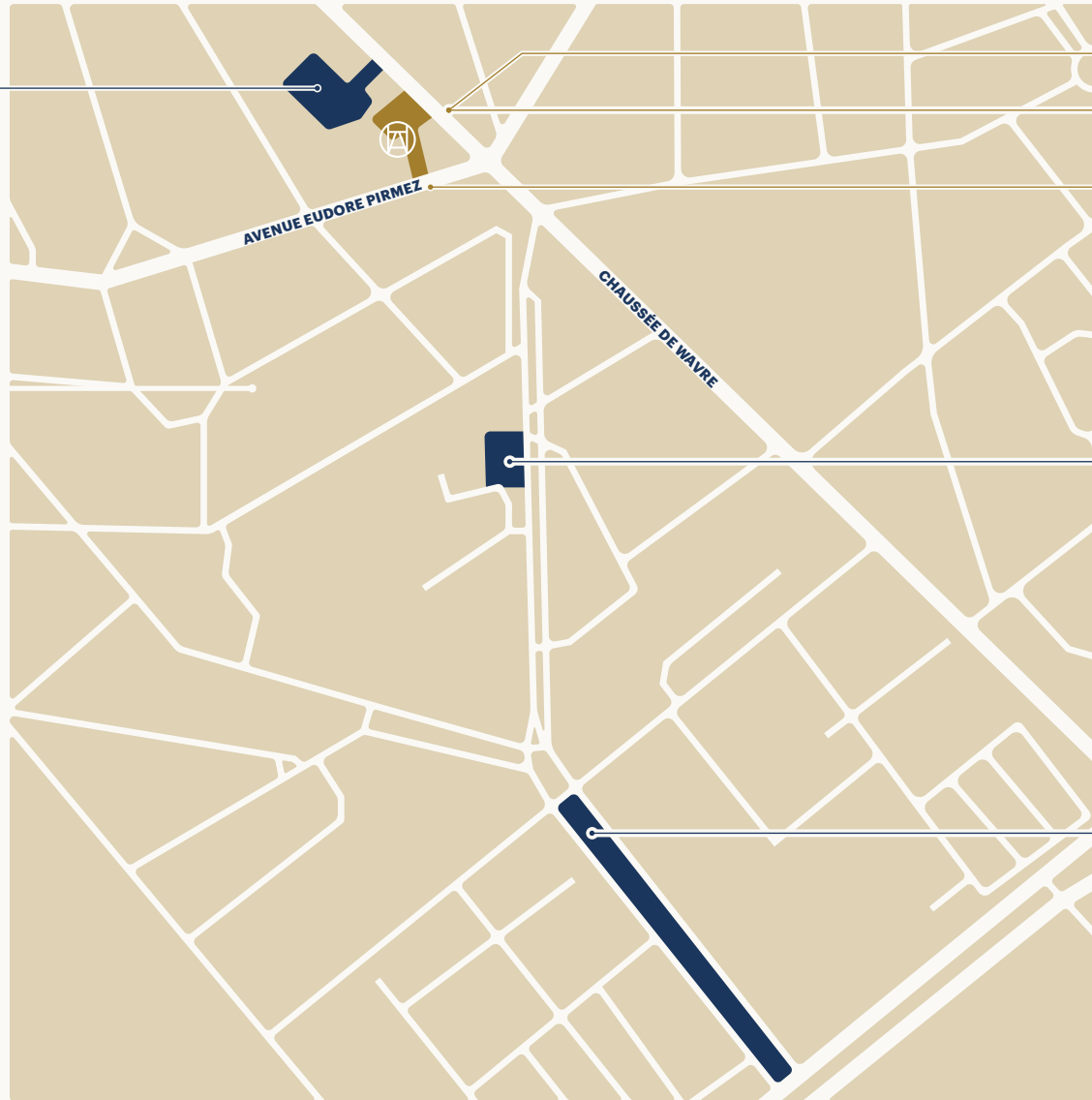

Bus 34

Bus 36

Tram 81



Parking Town Hall

31 Avenue des Casernes  
Etterbeek



Parking

Avenue du Deuxième  
Régiment de Lanciers

## Number of available parking places \*

		DAY	EVENING	DISTANCES
<b>Covered car parks</b>	Total Covered	130	165	
	Town Hall	80	95 <sup>2</sup>	Walking distance (300m)
<b>On street car parks</b>	Avenue 2 <sup>e</sup> Reg. Lanciers	200	200	500-750m (Shuttles)
<b>Total</b>		<b>330</b>	<b>365</b>	

## Tariffs parking spaces (VAT Excluded)

<b>Townhall</b>	<p><b>1€/hour reserved/place reserved</b> Free exit ticket given in exchange for their entry ticket. Covered car park, secure 24/7.</p>
<b>Av. 2<sup>e</sup> Reg. Lanciers</b>	<p><b>Flat fee 500€ / 2€/hour reserved/place reserved</b> Car park is on the road, not secured and 500 to 750m from our site. Need for shuttles and on-site surveillance. No ticket, no code.</p>

\* Request for rental must be managed via Albert Hall Brussels one month in advance / <sup>1</sup> After 19h / <sup>2</sup> After 17h / <sup>3</sup> Per place reserved

# PARKING VIP

**Trucks parking area**  
± 4 trucks of 20m<sup>3</sup>

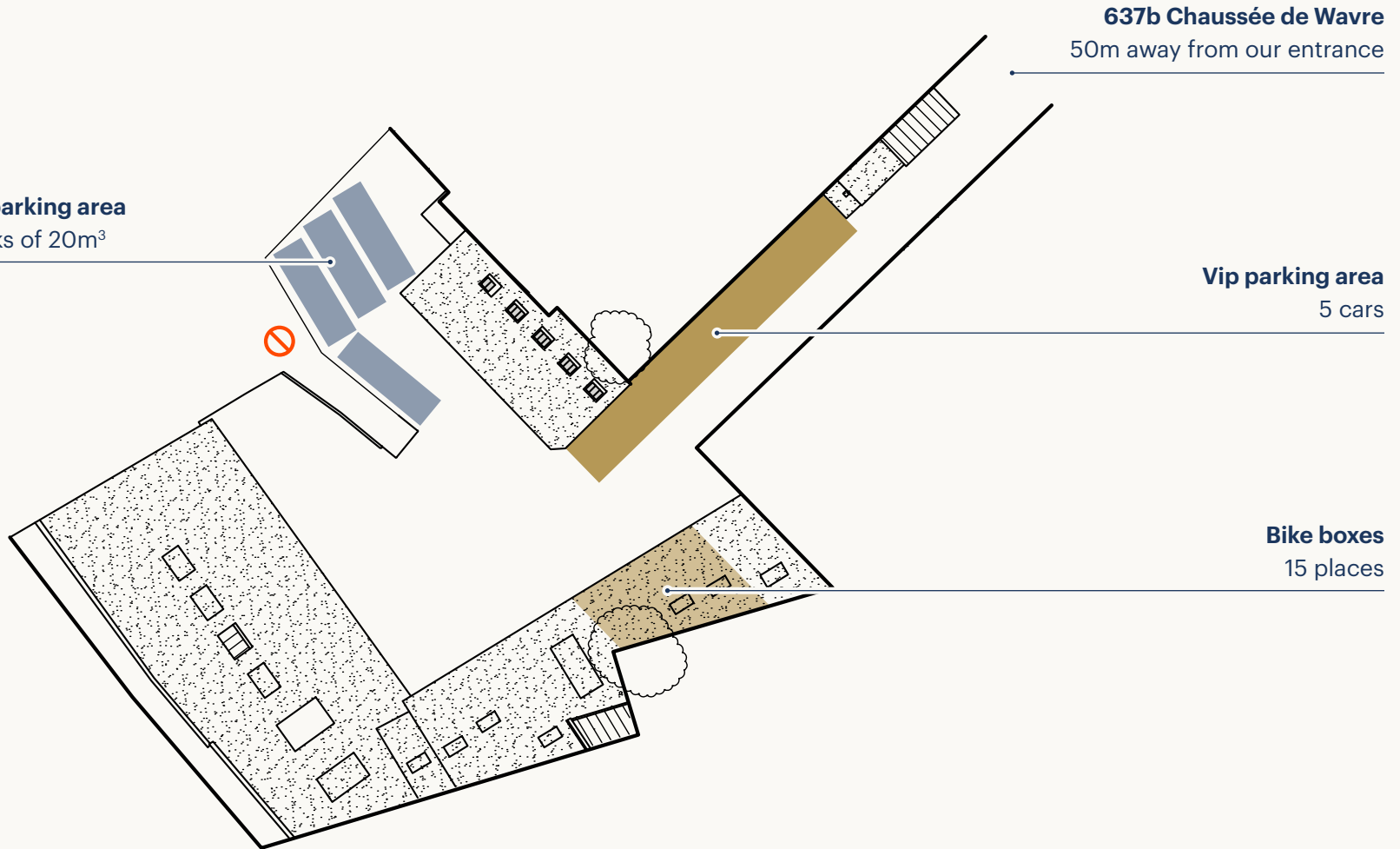

**637b Chaussée de Wavre**  
50m away from our entrance

**Vip parking area**  
5 cars

**Bike boxes**  
15 places

# DELIVERY ZONE



## DELIVERY ZONE

21m just in front of our building

To be booked if necessary  
with the municipality  
by the Albert Hall Brussels

# PUBLIC TRANSPORT

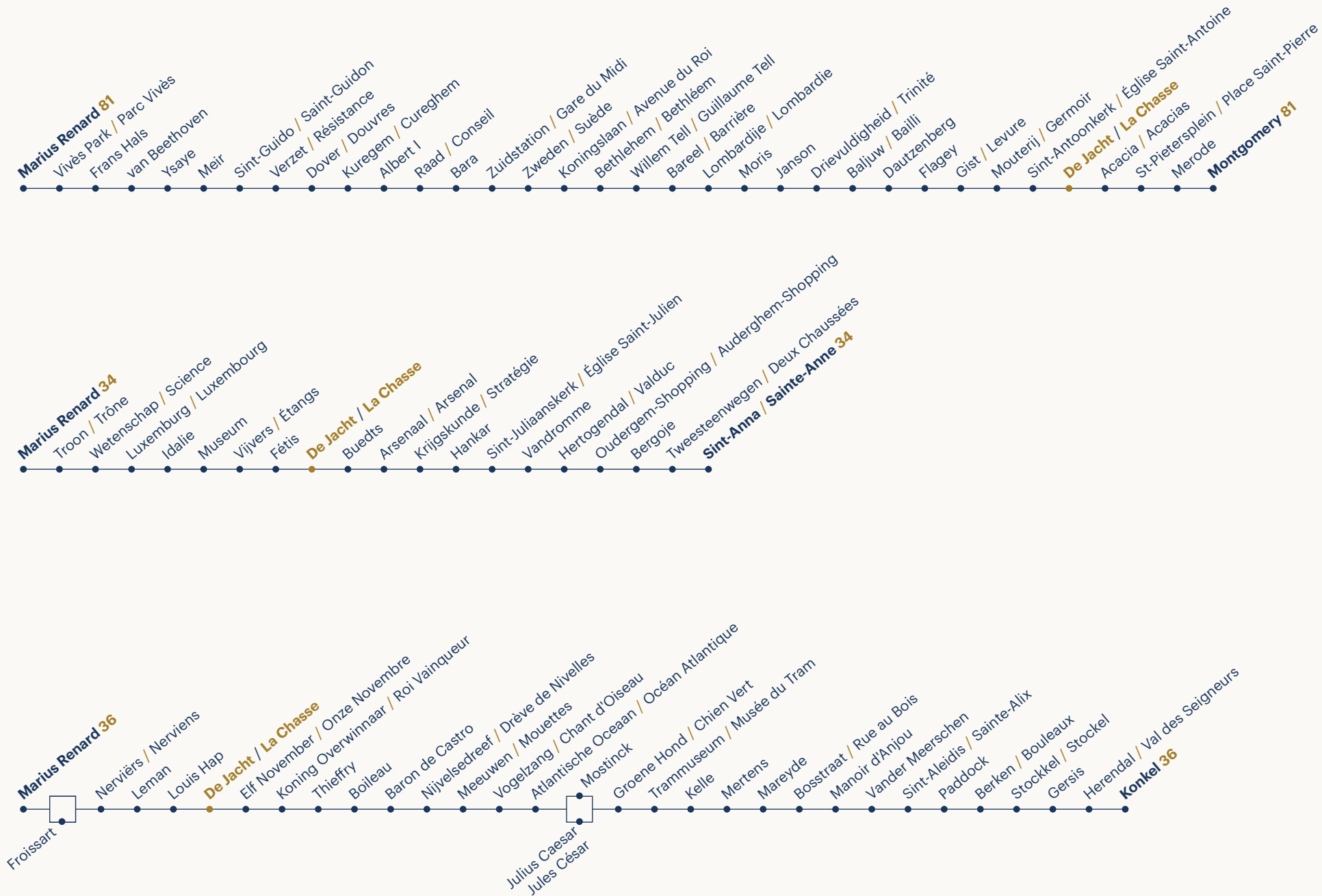

# SHUTTLE



## SHUTTLE SERVICES

### Modern Car

We recommend you their services

+32 2 420 10 00  
[info@moderncar.com](mailto:info@moderncar.com)



**ALBERT  
HALL** BRUSSELS

---

Chaussée de Wavre, 649-651  
B-1040 Brussels

T +32 470 66 44 89 / [info@albert-hall.com](mailto:info@albert-hall.com)

[www.albert-hall.com](http://www.albert-hall.com)